

roof plan as proposed
scale 1:50 @ A1

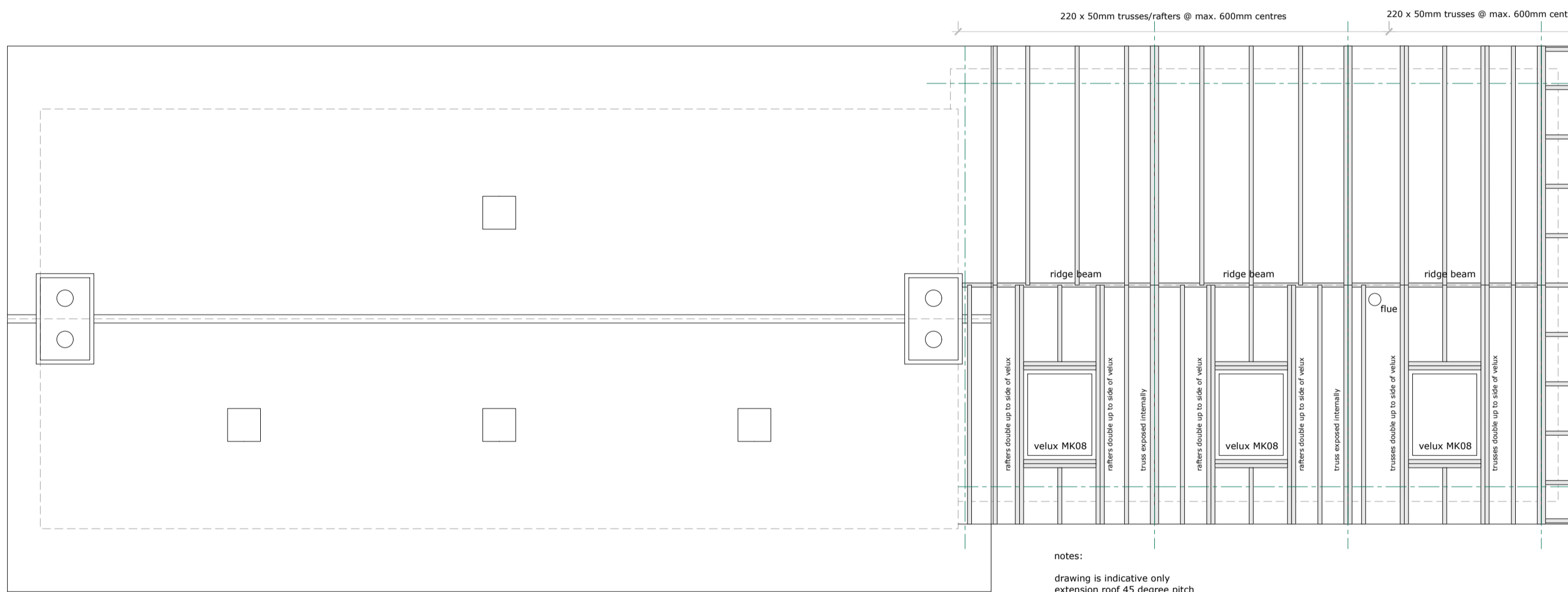

roof truss/rafter plan as proposed
scale 1:50 @ A1

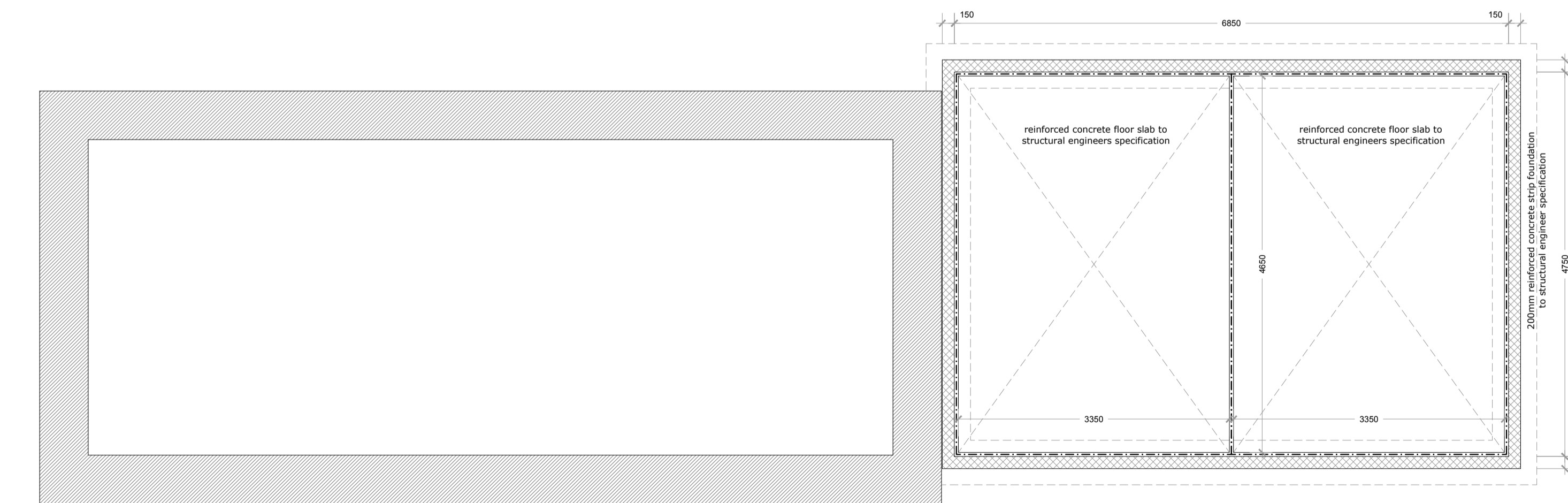

foundation plan as proposed
scale 1:50 @ A1

NOTE:
All sizes to be taken and checked on site by the contractor prior to preparation of shop drawings or fabrication of parts.
This drawing should not be scaled. Any discrepancies to be brought to the immediate attention of the architectural designer.
Copyright of design and drawing reserved.

NOTES

WALL CONSTRUCTION
Extension clad in 20mm vertical larch, on 50mm timber battens, on 25mm counter battens.
Internal leaf to consist of Breather FR Foil Membrane by YBS Insulation, on 9mm thick exterior grade treated plywood sheathing (WBP to BS 6566), on ex 150 x 50mm s.w. C16 stud framing at 600mm c/s, with 150mm Frametherm insulation quilt inset between studs, on 1 layer G66 MU polythene vapour barrier, on 25mm Celotex FR5000, on 38 x 50mm battens to provide service void, on 12.5mm T & F plasterboard finish internally.
Specified extension wall construction to achieve U-value 0.17 W/m²K.
See U-value calculations for details.

ROOF CONSTRUCTION
Natural slate roof to extension, on 1 layer Roofshield on 150 x 22mm butt jointed sarking board on manufactured roof trusses/rafters to BS 5268 part C at max 600mm c/s, with 200mm rigid insulation board, on 2 layers 12.5mm T & F plasterboard finish internally.
Glulam ridge beams to vaulted ceilings and trusses partially exposed within vaulted ceilings, as shown in drawings.
Specified roof construction to achieve U-value 0.15 W/m²K.
See U-value calculations for details.

GROUND FLOOR CONSTRUCTION
150mm compacted hardcore blinded with sand, 1200Gauge (300mu) polythene damp proof membrane, 150mm C10 concrete floor slab reinforced with A142 mesh with 12mm fibroland around edges to allow for expansion, 200mm rigid insulation board, 65mm concrete screed, floor finish tbc.
Specified floor construction to achieve U-value 0.18 W/m²K.
See U-value calculations for details.

MEZZANINE STORAGE FLOOR CONSTRUCTION
22mm chipboard on 220 x 50mm solid timber trusses/joists at 600mm c/s, on 1 layer 12.5mm plasterboard to GF ceiling.

NEW INTERNAL PARTITION
One layer of 12.5mm gyproc wallboard each side of 75mm gyproc pyframe 75 x 50 'C' studs at 600mm centres to provide 30 minutes fire resistance.
Moisture resistant wallboard to all wet area side of partitions, ie. en-suites, toilets, kitchen etc.
All partitions to be constructed in accordance with manufacturers written instructions and recommendations including junction details to avoid flanking, gyproc ceiling and gyproc firestrips as indicated. Any alternative partition specification to be confirmed by the contractor as equal to the above and to meet with required fire resistance.

DRAINAGE
All existing drainage provisions to be checked for purpose and retained.
Contractor to investigate existing drainage system and complete design for connection of new foul drainage in accordance with BS EN 12056-1; 2000 and BS EN 12056-2: 2000 and wastewater drainage to be in accordance with BS EN 12056-2: 2000.
Below ground drainage and sewer system to be designed and installed in accordance with BS EN 752: 2008 and comply with all Local Authority Bylaws.
All new drainage connected to existing soil stacks (where possible) and to comprise of the following:
WC's - 110mm dia. drainage pipework
WHB's - 32/40mm dia. drainage pipework
Sinks - 32/40mm dia. drainage pipework
Anti-siphon traps to sinks, WHB's as necessary and air admittance valve at end of new drainage run.
All SYP's to have roddable access / cleaning eye at all bends in main runs.
Stub stacks to be provided where necessary with air admittance valve above the highest water level of the appliances it serves.
All pipework to be concealed and installed to allow adequate access for testing / maintenance.
Fire collar to be installed where pipes pass through fire rated wall or floor to maintain fire integrity. Slove bends to be installed where required.

HEATING SYSTEM
Radiators to extension connecting to existing heating system. Electric heating powered by dump load from the wind turbine.
Wood burning stove for back up, Charmwood C-Four 4.9kW.
All setting out to be subject to detailed site survey by contractor prior to construction.

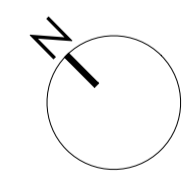

HEGER
ARCHITECTURE & DESIGN

35 LINDY ROAD
INVERLOCHY
FORT WILLIAM
PH3 6NZ
t. +44 (0) 1397 70 4515
m. +44 (0) 7933 502 993
e. kirstine@igmail.com

Project	COTTAGE EXTENSION BE-ACH, LOCHALINE, PA80 5XD	Scale	1:50@A1
Client	MR TOBY ROBINSON	Date	18/11/20
Title	EXTENSION PLANS AS PROPOSED	Job No.	202007
Issue Purpose	BUILDING WARRANT	Dwg No.	BW02
		Drawn	KH
		Rev.	B